





**1) PROPOSED CONSOLIDATION OF PORTION 139 & PORTION 140 OF THE FARM CLIFTON NO.939**

**2) PROPOSED SUBDIVISION OF THE ABOVE PROPOSED CONSOLIDATION**  
**3) PROPOSED LEASE OVER PORTION A**

Situate in the eThekweni Municipality : Inner West Operational Entity,  
 Registration Division FT, Province of KwaZulu-Natal.

**NOTE:**

- 1) The figure ABCDEFGHJKLMNPQJ2K2L2M2N2 represents Portion 139 of The Farm Clifton No.939, measuring 25.2Ha. in extent.
- 2) The figure J2-H2 represents Portion 140 of The Farm Clifton No.939, measuring 31.3Ha. in extent.
- 3) The figure A-N2 represents the Proposed Consolidation of Portion 139 and Portion 140 of The Farm Clifton No.939, measuring 56.5Ha. in extent.
- 4)  The figure represents the Proposed Portion A of The Consolidated Erf of The Farm Clifton, measuring 10.6Ha. in extent.
- 5)  The figure represents the Proposed Portion B of The Consolidated Erf of The Farm Clifton, measuring 16.7Ha. in extent.
- 6)  The figure FGHIJKM middle of stream represents the Proposed Lease over Portion A of the Consolidated Erf of The Farm Clifton, 3.3Ha. in extent.
- 7)  The figure represents the Proposed Remainder of The Consolidated Erf of The Farm Clifton, measuring 28.8Ha. in extent.

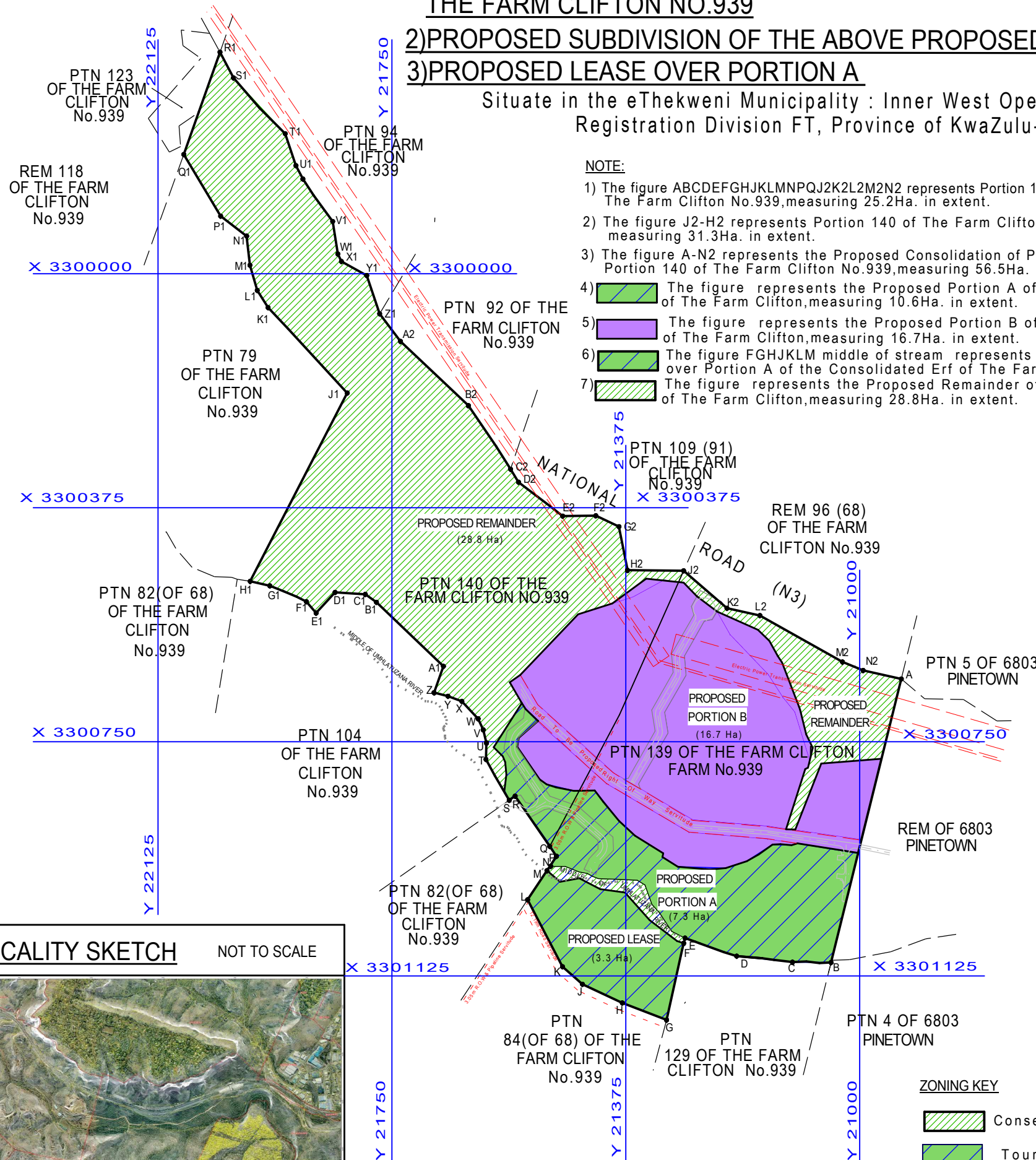

**LOCALITY SKETCH** NOT TO SCALE



**ZONING KEY**

-  Conservation Zone
-  Tourist
-  Clifton Canyon Bussiness

**REVISION NOTES.**

REV NO.	DESCRIPTION	DATE
001	CONSOLIDATION & SUB DIVISION	11/2015

OWNER : NATAL BOARD OF PROPERTY  
 ADMISTRATORS PROPRIETARY LIMITED  
 PROPOSED USAGE : CONSERVATION, TOURIST &  
 CLIFTON CANYON BUSINESS PARK  
 DIAGRAM : S.G. No. 28/1995 & S.G. No.29/1995  
 DEED : T8977/2004

STREET ADDRESS :

ALL MEASUREMENTS AND AREAS ARE APPROXIMATE  
 AND SUBJECT TO ACTUAL SURVEY

Prepared by :

W.I.M. TURNBULL Professional Land Surveyor

FILE: PIN181/APPLICATIONS  
 DRAWING : PIN181 APP REV01  
 DATE: NOV 2015

Prepared by :

**BUTTON & O'CONNOR INC.**  
 Professional Land Surveyors

Telephone 031-2662278 P.O. Box 1863  
 Fax : 031-2669753 Westville  
 16 Westville Centre, 3630  
 52 Norfolk Terrace,  
 Westville. 3630  
 Tel : (039) 7271564 P.O. Box 1921  
 Fax : (039) 7271564 Kokstad  
 4700

34 Strachan Street  
 Kokstad 4700

REVISION NO : 001  
 DRAWN BY : AN